



LIGHT BAFFLE/SEAL REPLACEMENT INSTRUCTIONS

As the old saying goes: "There are many ways to skin a cat"; so what I'm going to share with you here isn't the only way to do the job, but the way I have found to be easiest for me. Tools needed are: LBMM-KIT-2, Straight Edge Razor Blade, Exacto Knife, Straight Edge, Q-Tips, Tweezers, Slotted Screwdriver and Denatured Alcohol (figure 1)



1. **Removal of old light baffle:** Before you remove it, compare its thickness with the new light baffle so that you know what to use to replace it.

a. **Back Cover/Film Door:** First of all, determine if you are dealing with metal or plastic parts. If they are plastic, use no solvent stronger than Denatured Alcohol. If they are metal, MEK or Acetone will more than likely be OK (I prefer MEK). For areas where you have room, you can remove the old material with a cotton swab dipped in an appropriate solvent. For areas where the swab won't fit (i.e. film door channels), I use a standard slotted small screwdriver to first drip some solvent onto the old light baffle. I then use the same tool to scoop/scrape it out (figure 2). You can also do the same with the wooden end of the cotton swab after you have taken a pair of pliers to it to make it the correct width (figure 3). Besides the channel, don't forget to also replace the foam that is usually next to the door hinge.

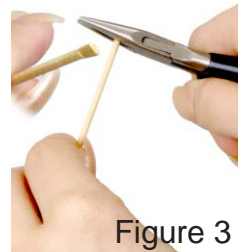

b. **Mirror Cushion:** First of all, I must warn you that the focusing screen can be damaged VERY easily (so don't even look at it wrong!). To remove the old mirror cushion, I will usually start with an exacto-type knife to remove the bulk of the product (figure 4). I will then use a cotton swab with denatured alcohol to remove the sticky "goo". **DO NOT USE** MEK or Acetone anywhere near the focusing screen as the fumes alone can damage the screen.

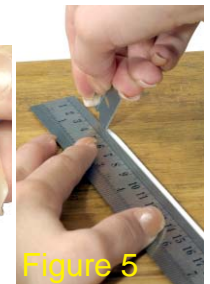

2. **Installing new light baffle:** I recommend cutting the light baffle from the back side on a cutting board using a metal straight edge/ ruler (figure 5). A pair of tweezers is very helpful when trying to place the new pieces you have just cut (figure 6). The film door channels will give you the biggest grief because the adhesive on the new light baffle will try to stick to the sides of the channel. If this frustrates you too much, you can stick the light baffle to black paper with its adhesive surface (figure 7 & 9) then cut to size what you need. Black paper can be found in most office supply/arts and crafts stores in the gel-pen section. Construction paper is too thick-- you need regular thickness paper. Then you will need an alternate adhesive like Pliobond (part # P-351-F) or Crystal Clear Glue (part # X001-F) to glue the light baffle with paper attached into the channels (figure 8).



Copyright Fargo Enterprises, Inc. © 2002
All rights reserved

Your Camera Repair/Restoration Tools and Supplies Headquarters

www.micro-tools.com